

TYPICAL TYPE V RESIDENTIAL CONSTRUCTION CBC 2007

THIS DRAWING DEPICTS MINIMUM CODE REQUIREMENTS PER CBC 2007. INFORMATION IS FOR REFERENCE ONLY AND IS NOT A SUBSTITUTE FOR ACCURATE DRAWINGS PREPARED FOR EACH PROPOSED CONSTRUCTION PROJECT.

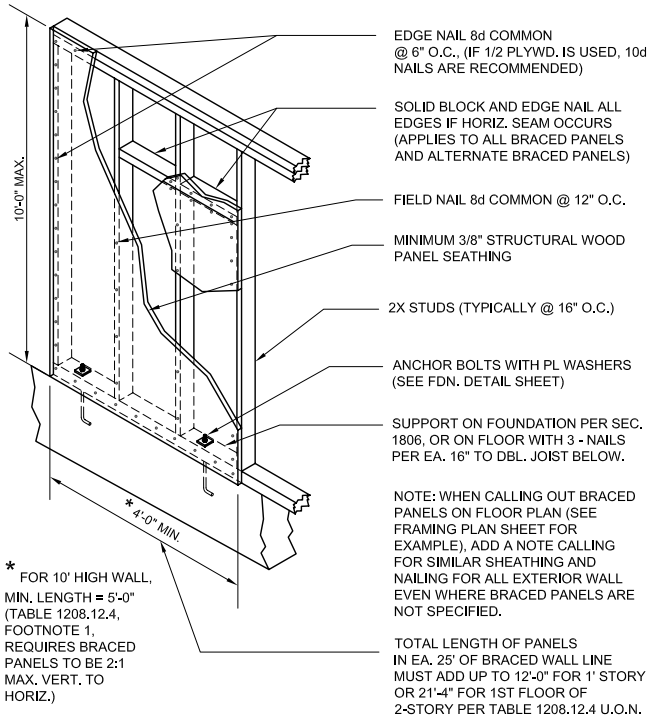

TYPICAL BRACED PANEL (TYPE 3 - WOOD STRUC. SHEATHING)

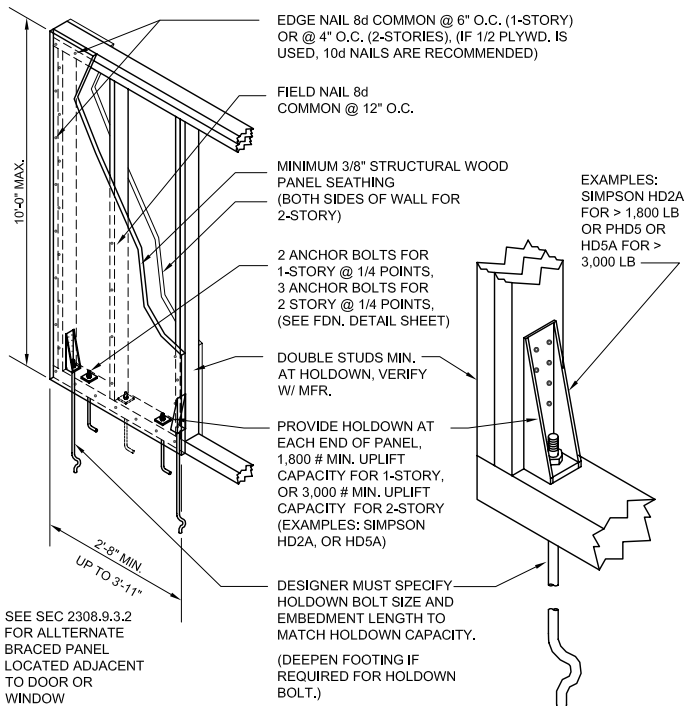

ALTERNATE BRACED PANEL

TYPICAL HOLDOWN DEVICE

Rules for Configuring the Braced Wall Panels:

Lateral Design for Conventional Construction may consist of "simple boxes" as shown in the diagram below. The total length of braced wall panels must conform to table 2308.12.4 for the Seismic Design Category ("SDC") and "Sds" applicable to the project site. The City of Santa Rosa is typically SDC = "D" with an Sds of > 1.0. If you are proposing to use braced wall panels, **you must note those values on the cover sheet of your drawings.** You can look up your latitude and longitude and find your exact SDC and Sds per Chapter 16, or just note SDC = D and Sds = > 1.0.

For **one story conditions**, the total length of braced panel for each 25' of braced wall line **must be 12'-0"** or equivalent (for example, 3 - 4'-0" braced panels, or 2 - 4'-0" braced panels plus 1 - 2'-8" alternate braced panel). **For the first floor of a 2-story condition**, the required total length per each 25' of braced wall line **must be 21'-4"** or equivalent. These minimum total lengths are for plywood sheathed braced panel. Gyp. Board braced panels must be the full 25'-0" (no openings for one story and are not allowed for two story, therefore are not usable in Santa Rosa).

Footnote 1 of table 2308.12.4 requires braced panels to be 2:1 max vert. to horz. This is 4'-0" min. for 8' plate lines, and 5'-0" min. for 10' plate lines. (The max. height is 10'-0".) Also, the same footnote allows you to reduce the total panel length for each 25' of wall line by 1/2 if you install the plywood on both sides and add holdowns similar to an alternate braced panel.

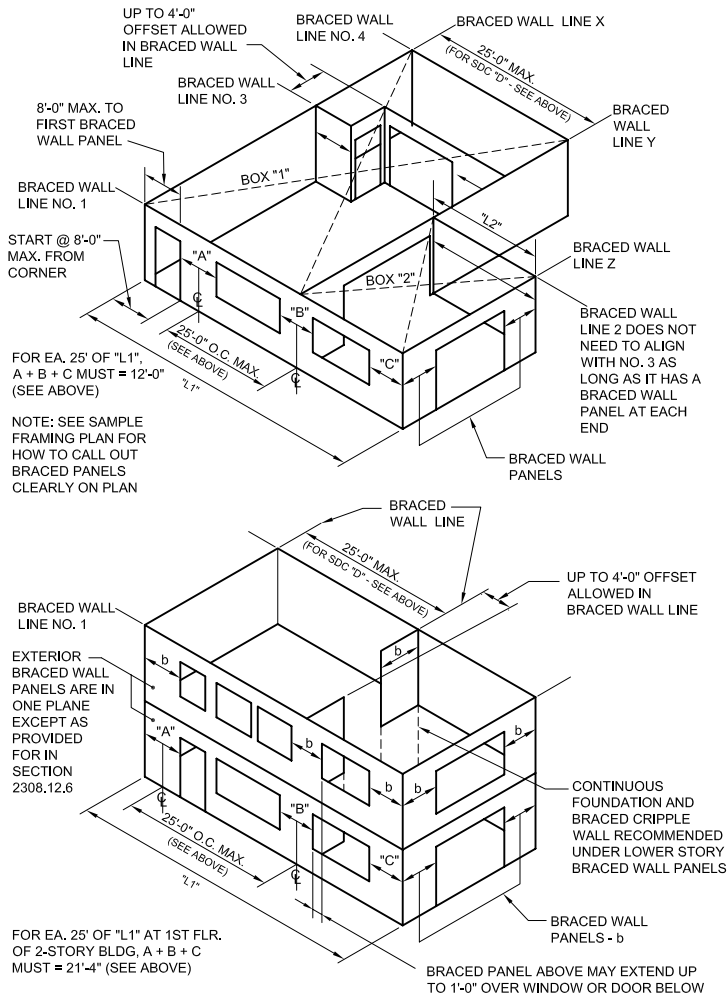

**FIGURE 2308.9.3 (FOR SDC "D")
BASIC COMPONENTS OF THE LATERAL BRACING SYSTEM**

NAME, ADDRESS AND PHONE NO. OF DESIGNER
XXX XXX XXX XXX
XXX XXX XXX XXX

WET SIGNATURE OF DESIGNER ON EACH SHEET
(AND PROFESSIONAL STAMP IF APPLICABLE)

EXAMPLE RESIDENCE

1234 MAIN ST.
SANTA ROSA, CA 95400
APN # 000-000-000

BRACED WALL SKETCH

SAMPLE DRAWING

SCALE: N.A.
DATE: SEPTEMBER 15, 2008

SHEET NO.
A12