

TYPICAL TYPE V RESIDENTIAL CONSTRUCTION CBC 2007

THIS DRAWING DEPICTS MINIMUM CODE REQUIREMENTS PER CBC 2007. INFORMATION IS FOR REFERENCE ONLY AND IS NOT A SUBSTITUTE FOR ACCURATE DRAWINGS PREPARED FOR EACH PROPOSED CONSTRUCTION PROJECT.

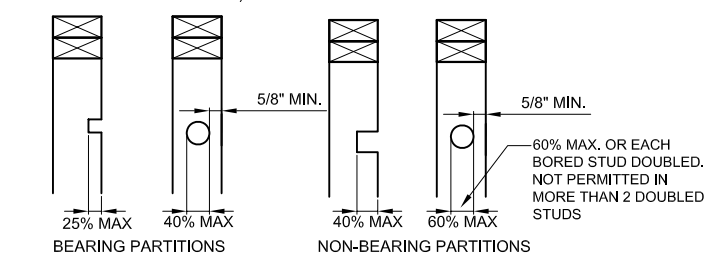

NOTCHING AND BORING: WALL STUDS (CBC 2308.9.10 / 2308.9.11)
 RAFTERS / CEILING JOISTS (CBC 2308.10.4.2)
 FLOOR JOISTS (CBC 2308.8.2)

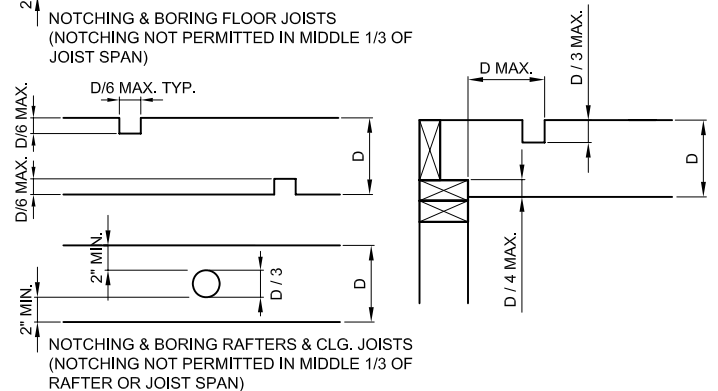
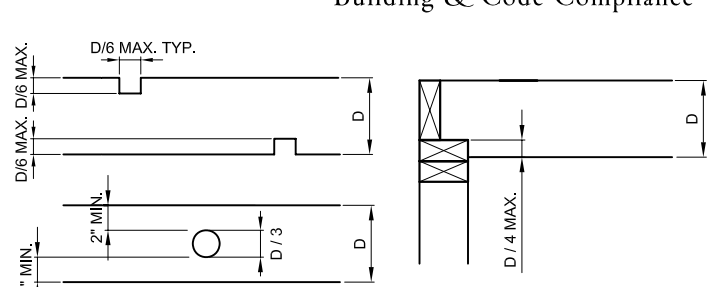
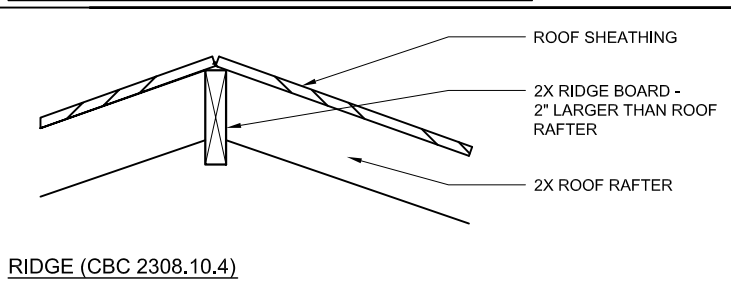
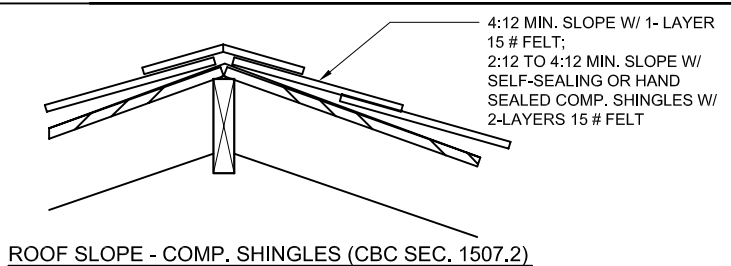
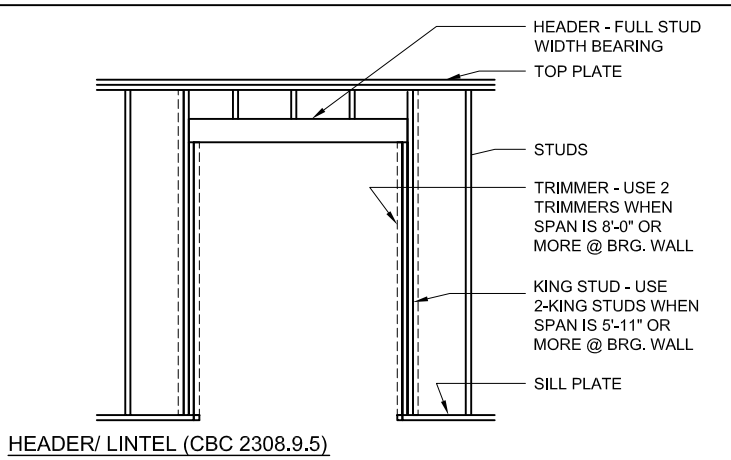
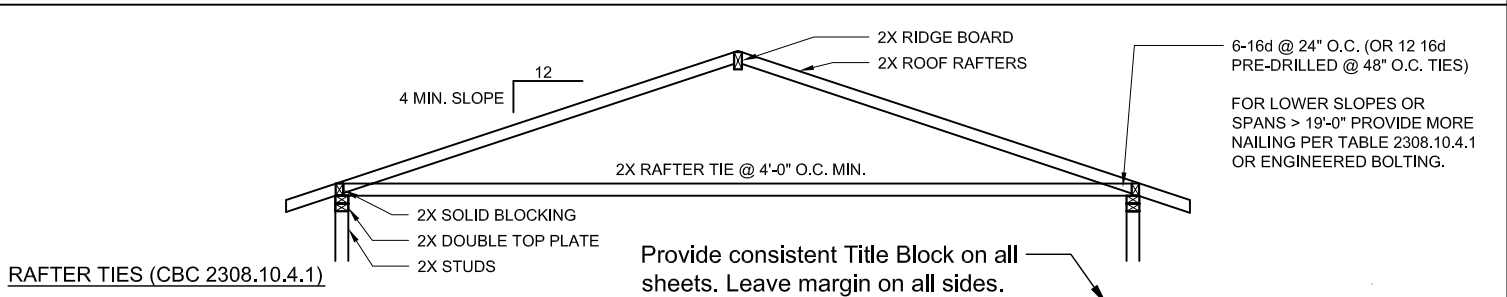
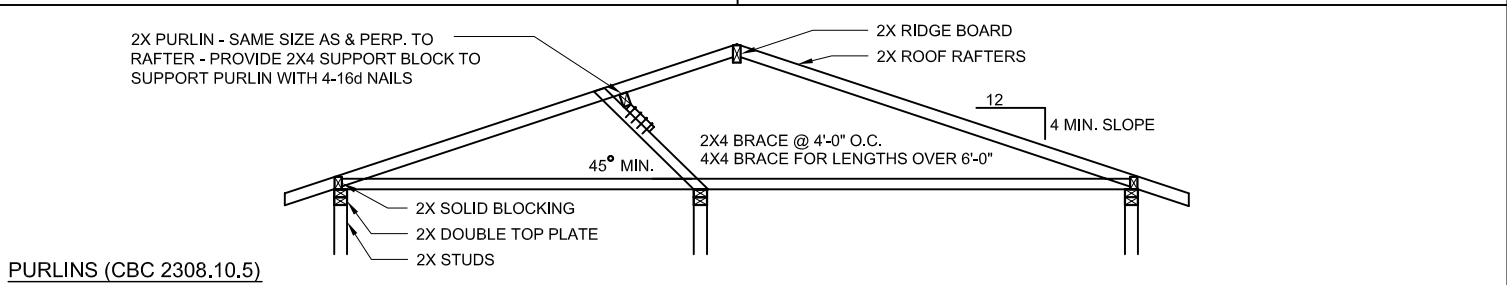

NAME, ADDRESS AND PHONE NO. OF DESIGNER
 XXX XXX XXX XXX
 XXX XXX XXX XXX

WET SIGNATURE OF DESIGNER ON EACH SHEET
 (AND PROFESSIONAL STAMP IF APPLICABLE)

E:\Bldg\DLV\ACAD\DETAILS\TYPE V A7 FRMG-NOTCH.DWG, 10/03/2008 2:22:44 PM

EXAMPLE RESIDENCE

1234 MAIN ST.
 SANTA ROSA, CA 95400
 APN # 000-000-000

FRMG. DETS. NOTCH DET.

SAMPLE DRAWING

SCALE: NTS
 DATE: SEPTEMBER 15, 2008

SHEET NO.
A7