

# WINDOW FLASHING DETAIL

THIS DRAWING DEPICTS MINIMUM CODE REQUIREMENTS PER THE 2019 CALIFORNIA CODE CYCLE - INFORMATION IS FOR REFERENCE ONLY AND IS NOT A SUBSTITUTE FOR ACCURATE DRAWINGS PREPARED FOR EACH PROPOSED CONSTRUCTION PROJECT

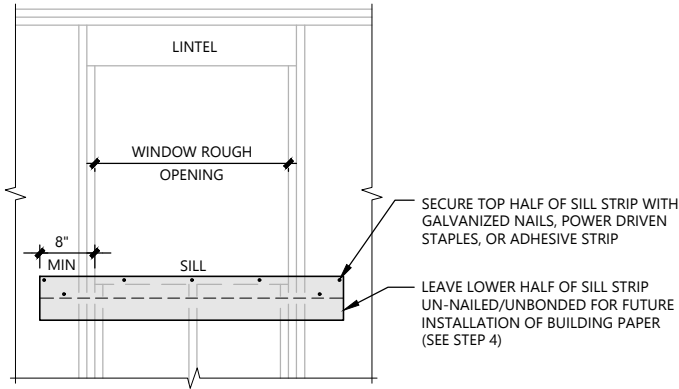

## STEP 1

INSTALL TOP EDGE OF SILL STRIP LEVEL WITH ROUGH SILL - EXTEND SILL STRIP AT LEAST 8" BEYOND BOTH EDGES OF ROUGH OPENING

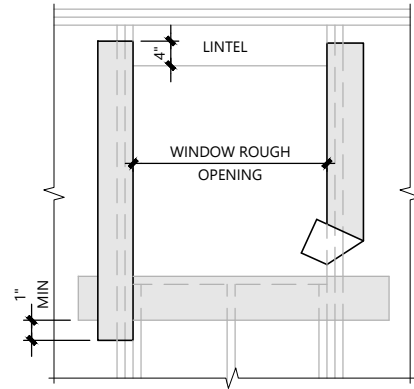

## STEP 2

ATTACH JAMB STRIPS WITH SIDE EDGE FLUSH WITH FACE OF ROUGH-JAMB FRAMING - START STRIP 1" BELOW LOWER EDGE OF SILL STRIP & EXTEND 4" ABOVE LOWER EDGE OF LINTEL

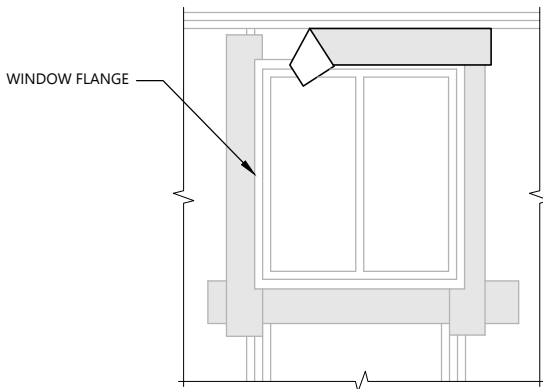

## STEP 3

INSTALL WINDOW INTO ROUGH OPENING WITH SILL AND JAMB FLANGES OVER PREVIOUSLY INSTALLED FLASHING - ATTACH HEAD FLASHING OVER THE WINDOW FLANGE

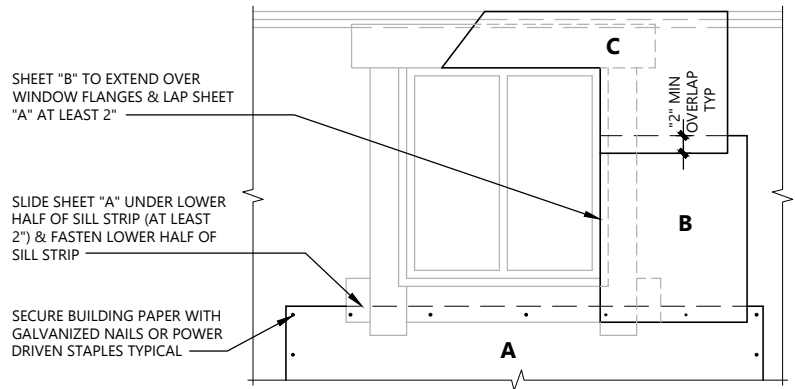

## STEP 4

COMMENCING AT THE BOTTOM (SOLE PLATE) OF THE WALL, LAYER BUILDING PAPER UNTIL WALL IS COVERED (A, B, C, ETC.)